

**GENERAL NOTES**

1. THIS BUILDING IS DESIGNED IN ACCORDANCE WITH THE PENNSYLVANIA CODE, TITLE 54, LABOR AND INDUSTRY
2. BUILDING OCCUPANCY CLASSIFICATION:  
 PROPOSED: A-1, ASSEMBLY FOR 501 OR MORE
3. BUILDING CONSTRUCTION CLASSIFICATION:  
 TYPE 5A, WOOD FRAME, ONE HOUR PROTECTED.
4. BUILDING AREA: BASEMENT AREA: 9,211 S.F.  
 FIRST FLOOR AREA: 8,064 S.F.  
 TOTAL BUILDING AREA: 16,275 S.F.
5. ALL DIMENSIONS ARE TO FACE OF STUD & CENTERLINE OF OPENING UNLESS OTHERWISE NOTED.  
 ALL STUD WALLS ARE 3-1/2" UNLESS OTHERWISE NOTED.  
 ALL EXTERIOR WALLS ARE 5-1/2" UNLESS OTHERWISE NOTED.
6. HANDICAP ACCESS & FACILITIES ARE PROVIDED IN ACCORDANCE WITH AMERICAN NATIONAL STANDARDS REQUIREMENTS.
7. THE BARDEN COMMERCIAL DIVISION IS NOT RESPONSIBLE FOR THE ACCURACY OF MODEL NUMBERS, SIZES, DIMENSIONS, ETC., OF ALL F.F.A.E. INDICATED ON THESE PLANS, WHICH IS NOT SUPPLIED BY BARDEN. THIS INCLUDES ITEMS SUCH AS BAPTISTRY UNITS, STEEPLE, ELEVATOR, HANDICAP LIFT, FOLDING PARTITIONS, SPECIAL WINDOWS AND DOORS, KITCHEN EQUIPMENT, ETC., OWNER AND/OR CONSTRUCTION MANAGER MUST VERIFY ALL INFORMATION BEFORE ORDERING AND CONSTRUCTION.

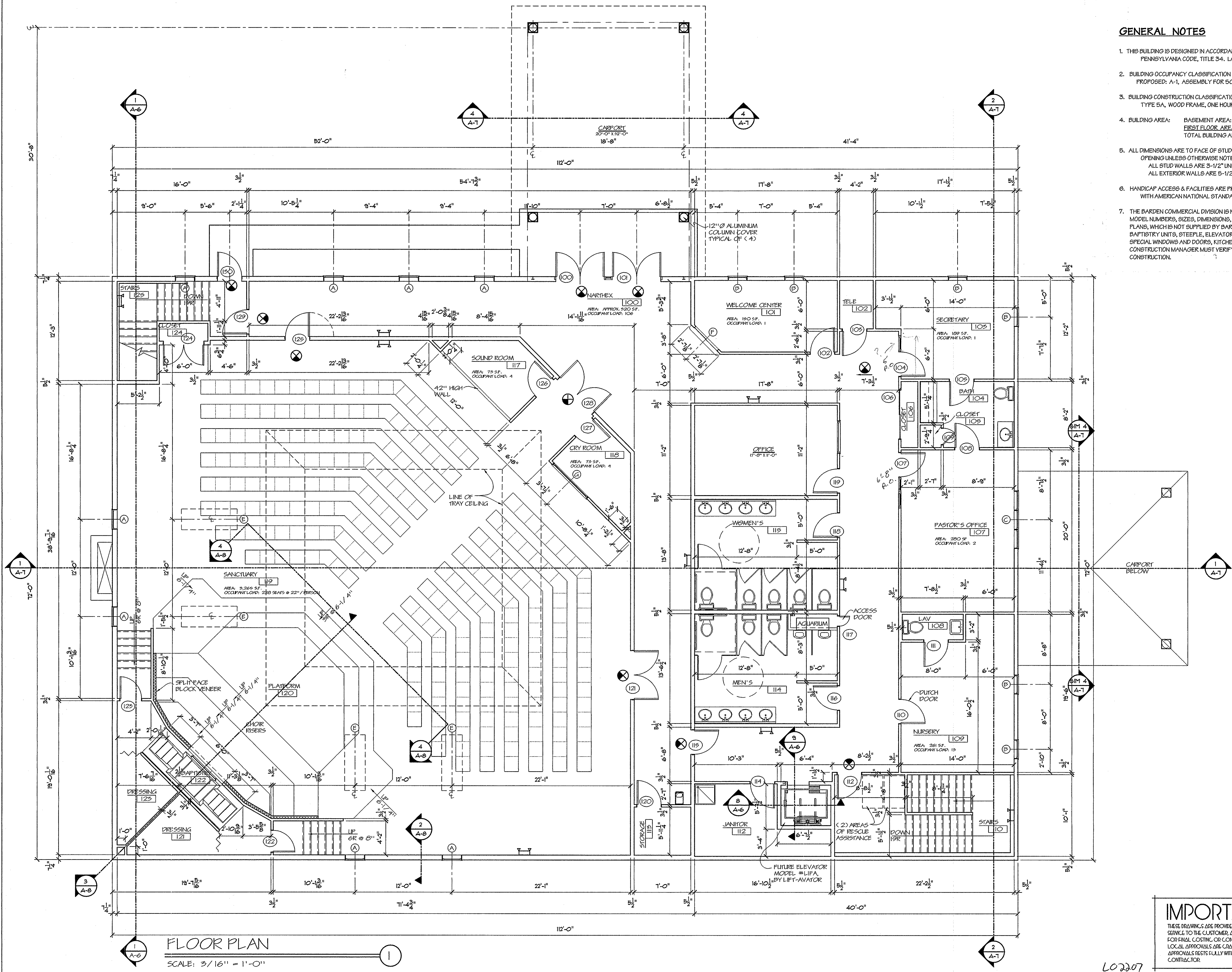

**FLOOR PLAN**  
 SCALE: 3/16" = 1'-0"

**IMPORTANT NOTICE**  
 THESE DRAWINGS ARE PROVIDED BY BARDEN COMMERCIAL DIVISION AS A SERVICE TO THE CUSTOMER, AND ARE NOT TO BE CONSIDERED COMPLETE FOR FINAL COSTING OR CONSTRUCTION UNTIL ALL FEDERAL, STATE OR LOCAL APPROVALS ARE OBTAINED. THE RESPONSIBILITY OF SECURING THESE APPROVALS RESTS FULLY WITH THE CUSTOMER AND/OR THEIR CONTRACTOR.

| REVISION NUMBER | REVISION              | DATE    | BY  |
|-----------------|-----------------------|---------|-----|
| 1               | ADDED A.R.A. @ STAIRS | 7-24-02 | CAM |
| 2               | ADD LUL/LA ELEVATOR   | 9/1/02  | CAM |

COPYRIGHT BARDEN & ROBESON CORP 2002  
 NOTICE: THIS SET OF PLANS IS THE PROPERTY OF BARDEN & ROBESON CORP AND MAY NOT BE USED FOR BUILDING UNLESS A PROPER CONTRACT HAS BEEN EXECUTED FOR THE PURCHASE OF MATERIALS TO COMPLETE THE DESIGN FROM BARDEN & ROBESON CORP



P.O. Box 310 Middleport, New York 14105  
 800-724-0141 • Fax 716-735-3752 • 716-735-3752

PROJECT TITLE:  
**GRACE OF CALVARY BAPTIST CHURCH**  
 PROJECT LOCATION:  
**ERIE, PA**

DEALER:  
**WAKELEY ASSOCIATES, INC.**  
 BILL WAKELEY

SHEET:  
**FIRST FLOOR PLAN**

DATE: 7/11/02 SCALE: AS SHOWN DRAWN BY: CAM

PROJECT NO.:  
**2040.01**

PROCESSING NO.:  
 DRAWING NO.:  
**A-3**

SHEET 1 OF 1

L02207